

# Laundry

COLLECTION 24

*Australian Designed  
Globally Inspired*

CURATED IN  
AUSTRALIA

— AUSTRALIAN INSPIRED

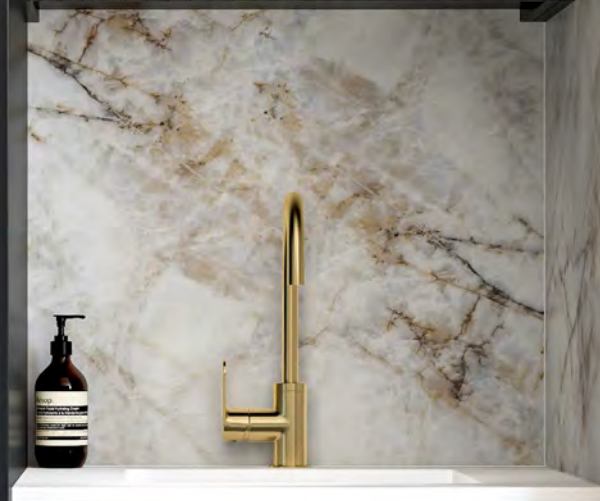

**otti**  
australia





# What Makes a Otti Laundry Outstanding

The Otti brands Quality and Sustainability are the cornerstone of Otti Australia.

Our products are backed by a comprehensive warranty, ensuring that you purchase with confidence. And because we believe that sustainable construction is essential for the future of our planet, we use recyclable materials and materials that last the test of time.

## 10 YEAR WARRANTY

It is with pure confidence that we guarantee all our laundry cabinets for a full 10 years.  
We believe in what we do!

Connect and Share your projects with us!





# Know the Difference

At Otti Australia, we curate and design our products with only the best materials in mind. While quality and sustainability are our focus, it is partnered with industry met compliancy and warranty, knowing there is intergrity in every product we offer.

## What Makes Us Different

What makes us different is our process towards "thoughtful design" and use of materials that boast many benefits, The thoughtful design process leans towards a more sustainable future for a

All Otti joinery are using plywood, that host the natural properties of layed timber sheeting that are laminated together using low VOC materials making for the best material to use in wetspaces. Waste is managed responsibly through recycling efforts encompassing packaging, waste and supporting the community through goodwill support and disaster relief efforts.

On going maintainace such as sealants, polish or wax are not required with Otti Australia cabinets making for a more sustainable product, unlike timber vanities.

## Benefits of Plywood -

- Water Resistant
- Durable, long lasting and strong
- Sustainable
- No maintenance required.

While others use inferior PVC, Chipboard or MDF.

- Chipboard or MDF are:-
- Not water resistant
  - Damage easily
  - Shorter life span
  - Not environmentally friendly.
  - Toxic glues and plastics used to manufacture these.

While Solid Timber need restaining every year once it is exposed to water, using chemicals required to maintain, polish or seal.

With many years experience in manufacturing bathware, the benefits of plywood vanities out weigh and out perform any other materials.

## Standard Features:-

- Soft Close Doors and Drawers
- High Quality detailed construction
- Perfect laminated edging





# CURATED IN AUSTRALIA

— AUSTRALIAN INSPIRED

With obsession to detail, our designers are inspired by the young and vibrant spirit of Australia.

Inspired by the latest trends in interior design, we bring you the latest collection by Otti Australia.

Being in the industry as an interior designer in the building industry for many years, understanding that quality, design and price entwined makes all the difference.



## MIX AND MATCH

You can mix and match your selections from our huge range of cabinet colours and handles. Personalise your items to create the perfect look!

## EASY DIY INSTALLATION

DIY Installation is easy with our modular system. Each module is built ready for you to install. No flat packs here!!





# Designing the best room in your home.

When it comes to the laundry, this space always takes a backseat to the stars of the home, Bathrooms and Kitchens. The laundry has always been a difficult space to design for and find the materials to get the designer look.

At Otti we have designed a modular system that will make designing your laundry easy. We have done all the planning for you with our



**Laundry Packages**  
or you can



**Build Your Own** design using the individual items.

*Australian Designed  
Globally Inspired*









# CONTENTS

Getting Started 01

---

Choose Your Style 02

---

Measure your Space 03

---

Base Cabinet Sets 04

---

Layout Using 1305mm Package 11

---

Layout Using 1715mm Package 15

---

Layout Using 1960mm Package 19

---

Cabinet Technical Drawings 23

---

Kitchen Accessories 27

Laundry Top Collection 29

---

Laundry Cabinet Finishings Collection 30

---

Sketch your Layout and Order Form 31

---

Laundry Warranty 34

---

# Getting Started

- Step 1. Style** - Choose your style and finishes  
**Step 2. Measure** - Measure out the space for your Laundry  
**Step 3. Layout** - Select from the Packages to fit your space - On Page 04  
**Step 4. Plan** - Use the planner on page 31 to ensure a great fit or build your own laundry.  
**Step 5. Order** - Place your order with our stockists or call our sales team to assist you.





## Step 1 Choose Your Style

### Cabinet Colour & Finishes

#### Timber Grain

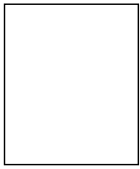

Byron



Black Oak



Natural Oak

#### Panelled

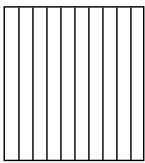

Marlo&Noosa



Marlo Matte Black



Noosa Matte White

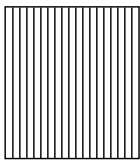

Bondi



Matte White

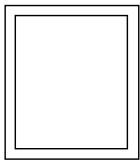

Hampshire



Matte White

#### Handle Options

Finish Electroplated PVD Handles

##### Byron, Bondi

Brushed Gold (Optional Colours available as extra) Included in Packages / RRP:\$20 Each



Matte Black  
BOHANDLE-B200



Brushed Gold  
BOHANDLE-G200



Brushed Nickel  
BOHANDLE-BN200

##### Marlo

Matte Black (Optional Colours available as extra) Included in Packages / RRP:\$20 Each



Matte Black  
MLHANDLE-B



Brushed Gold  
MLHANDLE-BG



Chrome  
MLHANDLE

##### Hampshire

Bevel Finger pull

#### Laundry Stone Tops



Quartz Stone  
Pure White  
20mm Stone Top



Natural  
Carrara  
18mm Stone Top

#### Laundry&Kitchen Sinks Options



##### Axon 52S M-CBS-810-52

Outer Dimension:  
520X440X220mm  
Basket Wastes Included

Included in Packages  
RRP:\$250



##### Axon 52S M-CBS-810-52BG

Brushed Gold  
Outer Dimension:  
520X440X220mm  
Basket Wastes Included

Upgrade to Brushed Gold Extra \$118  
RRP \$368



##### Axon 52S M-CBS-810-52GM

Gun Metal  
Outer Dimension:  
520X440X220mm  
Basket Wastes Included

Upgrade to Gun Metal Extra \$118  
RRP \$368



Byron Black  
Package D shown fits into a 1305mm space

## Step 2 Measure Your Space

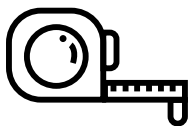

### MEASURE YOUR SPACE

Measure your laundry space

- Measure your floor - add doors and windows.
- Walls that your laundry will be fixed to. Draw in Windows, doors and ceiling height.

Considerations:-

Doors - Allow for the door swing and architraves.

Windows - Ensure you have allowed for your cabinets to clear window frames.

Wall to wall - Allow for tile thickness.

Mark out your waste points, drainage, plumbing and electrical positions.

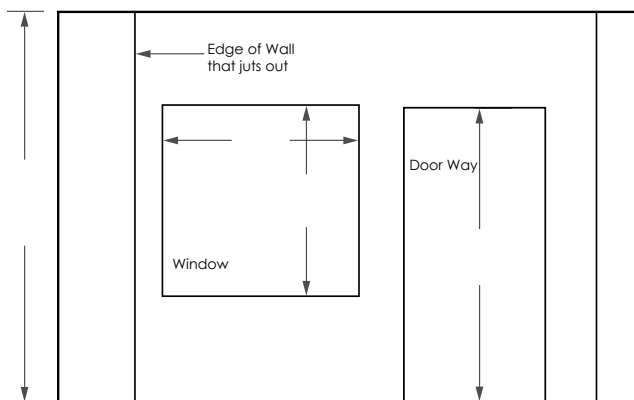
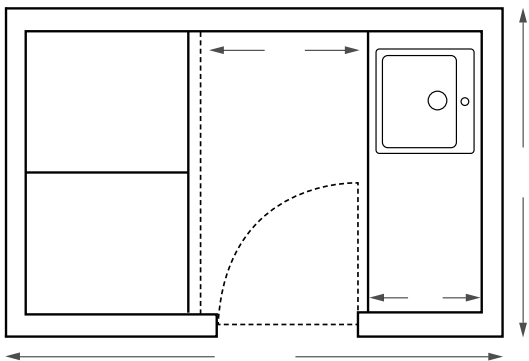

### Choose Your Layout

Once you know how much space you have to work with, think about the desired layout of the Laundry.

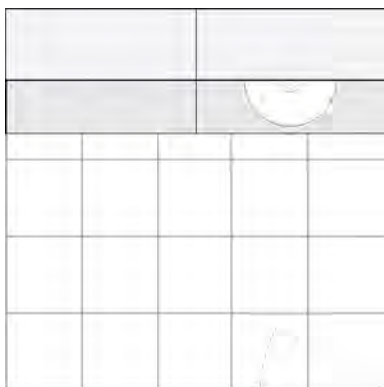

#### Straight Run Layout

Ideal for narrow spaces making for a simple and practical laundry

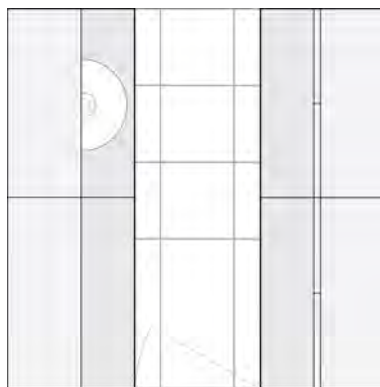

#### Galley Layout

Ideal for wide room, add cabinets on opposing walls to benefit from maximum storage space.



Refer to Page 31



- Allow for air to flow around your appliances

### Pro Tip - Consider Your Appliance Size

Note the width and depth of your appliances when designing your new laundry.

Most appliances are 600mm wide, but allow for 650mm so air flows around your appliances to avoid humidity to build up.

While depths may vary depending on brands and makes. The deeper they are they may protrude out from the benchtop when installed, rather than sit flush with the top edge.

**NOTE:** Always check with the manufacturers specifications for the required space around your appliance.

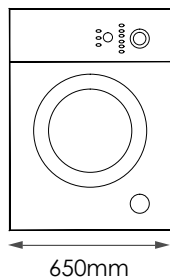
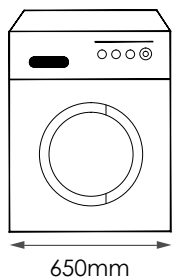
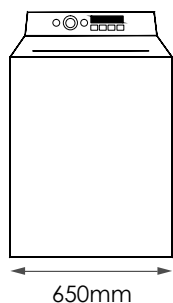





## BASE CABINET SETS Floor Standing Joinery

## Step 3 Choose a Package

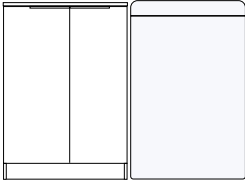

650mm

Base Cabinet 632mm x1  
Quartz Stone Top L650xD600xH20mm  
Laundry Sink Stainless Steel x1

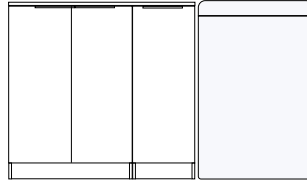

1060mm

Base Cabinet (Double Door) 632mm x1  
Base Cabinet (Single Door) 416mm x1  
Quartz Stone Top L1060xD600xH20mm  
Laundry Sink Stainless Steel x1

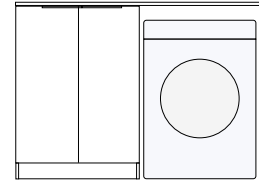

1300mm

Base Cabinet 632mm x1  
Quartz Stone Top L1300xD600xH20mm  
End Panel x1  
Laundry Sink Stainless Steel x1



### 650mm MINI LAUNDRY SET



### 1305mm LAUNDRY SETS

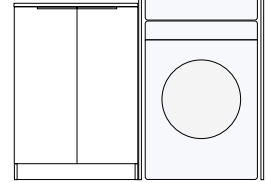
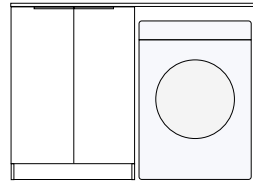
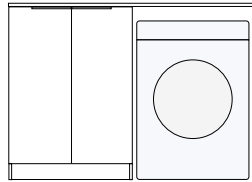
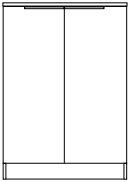
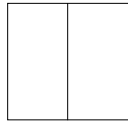
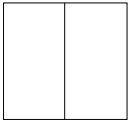

A

B

C

Base Cabinet 632mm x1  
Wall Cabinet 632mm x1  
Quartz Stone Top L650xD600xH20mm  
Laundry Sink Stainless Steel x1

Base Cabinet 632mm x1  
Wall Cabinet 632mm x1  
Quartz Stone Top L1300xD600xH20mm  
End Panel x1  
Laundry Sink Stainless Steel x1

Base Cabinet 632mm x1  
Wall Cabinet 632mm x2  
Quartz Stone Top L1300xD600xH20mm  
End Panel x1  
Laundry Sink Stainless Steel x1

Base Cabinet 632mm x1  
Wall Cabinet 632mm x1  
Tall Washing Machine Cabinet  
L652xD700xH2100mm x1  
Quartz Stone Top L650xD600xH20m  
Laundry Sink Stainless Steel x1



### 1715mm LAUNDRY SETS

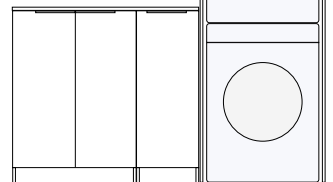
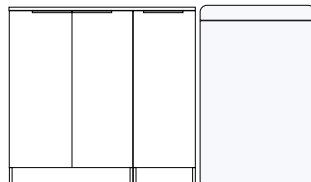
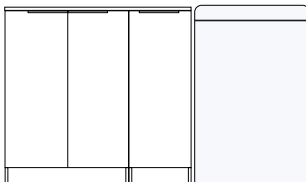
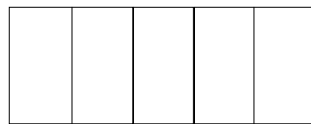
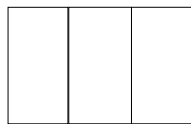

A

B

C

Base Cabinet (Double Door) 632mm x1  
Base Cabinet (Single Door) 416mm x1  
Wall Cabinet (Double Door) 632mm x1  
Wall Cabinet (Single Door) 416mm x1  
Quartz Stone Top L1060xD600xH20mm  
Laundry Sink Stainless Steel x1

Base Cabinet (Double Door) 632mm x1  
Base Cabinet (Single Door) 416mm x1  
Wall Cabinet (Double Door) 632mm x2  
Wall Cabinet (Single Door) 416mm x1  
Quartz Stone Top L1060xD600xH20m  
Laundry Sink Stainless Steel x1

Base Cabinet (Double Door) 632mm x1  
Base Cabinet (Single Door) 416mm x1  
Wall Cabinet (Double Door) 632mm x1  
Wall Cabinet (Single Door) 416mm x1  
Tall Washing Machine Cabinet  
L652xH2100mmxD700 x1  
Quartz Stone Top L1060xD600xH20m x1  
Laundry Sink Stainless Steel x1

# 1960mm LAUNDRY SET

Once you know how much space you have to work with, think about the layout of the laundry.

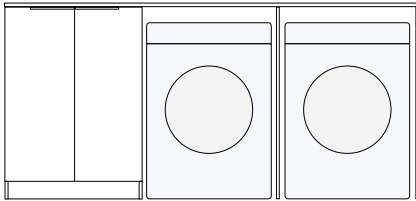
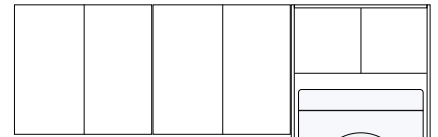
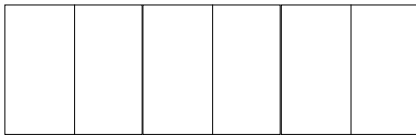

A

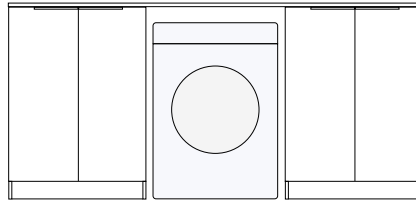

B

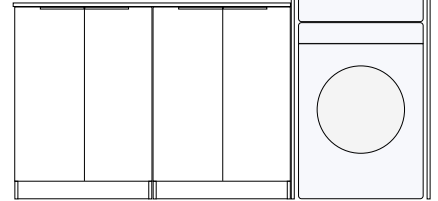

C

## Included In Package

Base Cabinet (Double Door) 632mm x1  
Wall Cabinet (Double Door) 632mm x3  
Quartz Stone Top L1980xD600xH20mm  
End Panel x2  
Laundry Sink Stainless Steel x1

Base Cabinet (Double Door) 632mm x2  
Wall Cabinet (Double Door) 632mm x3  
Quartz Stone Top L1980xD600xH20mm  
Laundry Sink Stainless Steel x1

Base Cabinet (Double Door) 632mm x2  
Wall Cabinet (Double Door) 632mm x2  
Tall Washing Machine Cabinet L652xD700xH2100mm x1  
Quartz Stone Top L1300xD600xH20mm  
Laundry Sink Stainless Steel x1



## FILLER AND END PANELS

Customise:- Use cabinets to fill majority of your space, then use our filler & end panels and end panels to fill the gaps. Remember to allow for air to flow around your appliances.

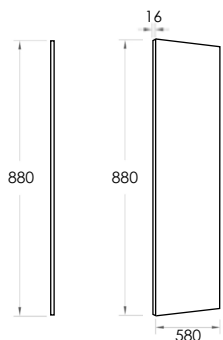
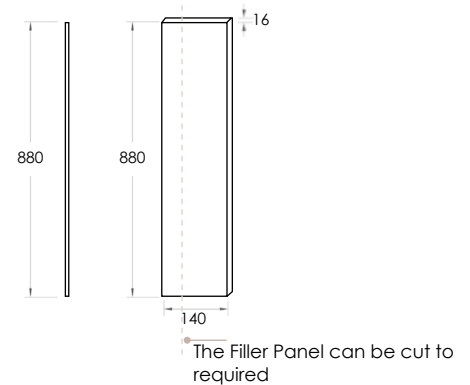
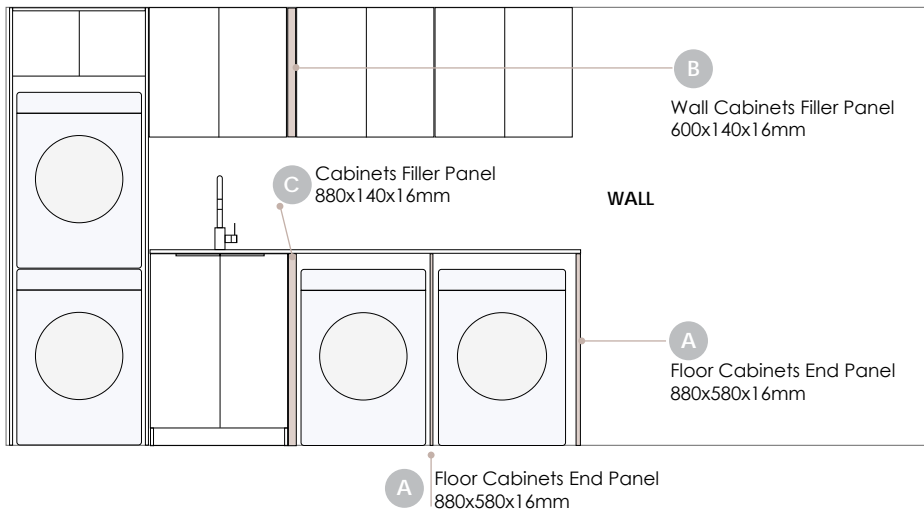

A Floor Cabinets End Panel 880x580x16mm

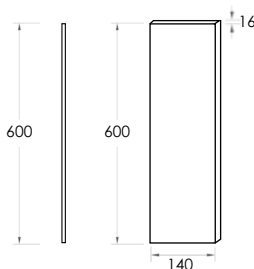

B Wall Cabinets Filler Panel 600x140x16mm Cut to Size on Site

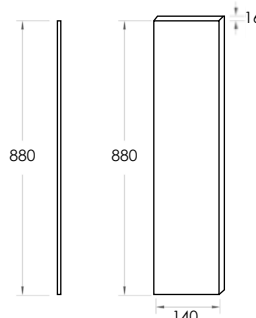

C Wall Cabinets Filler Panel 880x140x16mm Cut to Size on Site

## Finishes:

Available in all finishes



Natural Oak



Black Oak



Matte White



Matte Black



## GET THE LOOK

Complete laundry  
cost as pictured  
**\$2,090\***

\* Excludes :- Mirror, Tapware  
appliances and accessories





Noosa Matte White



## Mini 650mm

For those on a Budget the Mini Laundries are ideal for those laundries that need just simple tidy up!

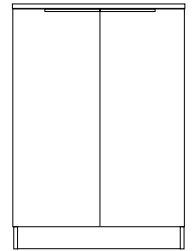
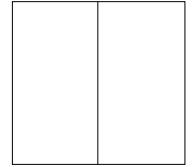

Byron Natural Oak



Byron Black Oak



Bondi MatteWhite

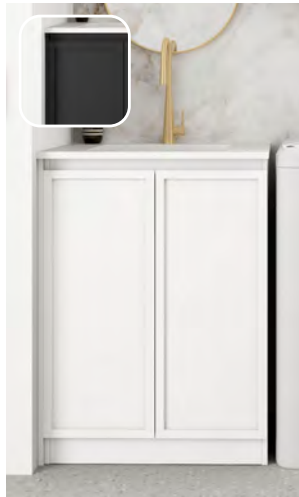

Hampshire Matte White&Matte Black



Marlo Matte Black



Base Cabinet 632mm x1  
Quartz Stone Top 650x600x20mm  
Laundry Sink Stainless Steel x1

**Byron Natural & Black Oak RRP: \$1,230**

LA-650-BYN-PW  
LA-650-BYN-NCA  
LA-650-BYB-PW  
LA-650-BYB-NCA

**Noosa RRP: \$1,375**

LA-650-NSW-PW  
LA-650-NSW-NCA

**Marlo RRP: \$1,375**

LA-650-MA-PW  
LA-650-MA-NCA

**Bondi RRP: \$1,375**

LA-650-BOW-PW  
LA-650-BOW-NCA

**Hampshire White & Black RRP: \$1,375**

LA-650-BOHW-PW  
LA-650-BOHW-NCA  
LA-650-BOHB-PW  
LA-650-BOHB-NCA



Base Cabinet 632mm x1  
Wall Cabinet 632mm x1  
Quartz Stone Top 650x600x20mm  
Laundry Sink Stainless Steel x1

**Byron Natural & Black Oak RRP: \$1,680**

LA-650A-BYN-PW  
LA-650A-BYN-NCA  
LA-650A-BYB-PW  
LA-650A-BYB-NCA

**Noosa RRP: \$1,975**

LA-650A-NSW-PW  
LA-650A-NSW-NCA

**Marlo RRP: \$1,975**

LA-650A-MA-PW  
LA-650A-MA-NCA

**Bondi RRP: \$1,975**

LA-650A-BOW-PW  
LA-650A-BOW-NCA

**Hampshire White & Black RRP: \$1,975**

LA-650A-BOHW-PW  
LA-650A-BOHW-NCA  
LA-650A-BOHB-PW  
LA-650A-BOHB-NCA

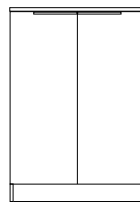
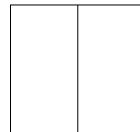
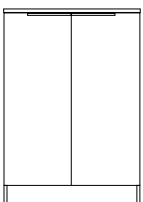





## Base Cabinet Set 1060mm Floor Standing Modules

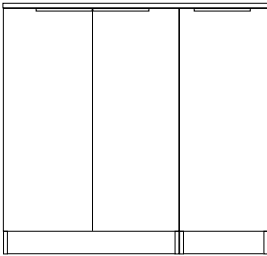

Byron Natural Oak



Byron Black Oak



Bondi Matte White



Noosa Matte White



Hampshire Matte Black & Matte White

Base Cabinet (Double Door) 632mm x1  
Base Cabinet (Single Door) 416mm x1  
Quartz Stone Top L1060xD600xH20m  
Laundry Sink Stainless Steel x1

### Byron Natural & Black Oak RRP: \$2,000

LA-1060-BYN-PW  
LA-1060-BYN-NCA  
LA-1060-BYB-PW  
LA-1060-BYB-NCA

### Noosa RRP: \$2,250

LA-1060-NSW-PW  
LA-1060-NSW-NCA

### Marlo RRP: \$2,250

LA-1060-MA-PW  
LA-1060-MA-NCA

### Bondi RRP: \$2,250

LA-1060-BOW-PW  
LA-1060-BOW-NCA

### Hampshire White & Black RRP: \$2,250

LA-1060-BOHW-PW  
LA-1060-BOHW-NCA  
LA-1060-BOHB-PW  
LA-1060-BOHB-NCA



## Base Cabinet Set 1300mm Floor Standing Modules

Base Cabinet 632mm x1  
Quartz Stone Top 1300x600x20mm  
End Panel x1  
Laundry Sink Stainless Steel x1

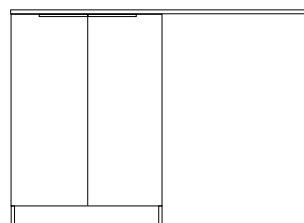

Noosa Matte White & Matte Black



Byron Natural Oak



Byron Black Oak



Noosa Matte White



Bondi Matte White



Marlo Matte Black

**Byron Natural & Black Oak** RRP: \$1,639  
LA-1300-BYN-PW  
LA-1300-BYN-NCA  
LA-1300-BYB-PW  
LA-1300-BYB-NCA

**Noosa** RRP: \$1,785  
LA-1300-NSW-PW  
LA-1300-NSW-NCA

**Marlo** RRP: \$1,785  
LA-1300-MA-PW  
LA-1300-MA-NCA

**Bondi** RRP: \$1,785  
LA-1300-BOW-PW  
LA-1300-BOW-NCA

**Hampshire White & Black** RRP: \$1,785  
LA-1300-BOHW-PW  
LA-1300-BOHW-NCA  
LA-1300-BOHB-PW  
LA-1300-BOHB-NCA





## Base Cabinet Set 1960mm Floor Standing Modules

Base Cabinet (Double Door) 632mm x1  
Quartz Stone Top L1960xD600xH20mm  
End Panel x2  
Laundry Sink Stainless Steel x1

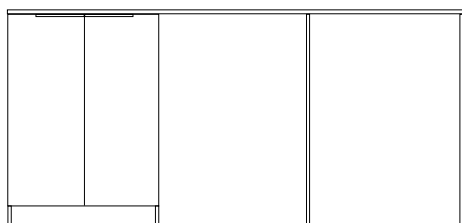

Byron Natural Oak & Black Oak RRP: \$2,456  
Marlo, Bondi, Hampshire White & Black RRP: \$2,601



## Design your Own Laundry!!!

Create your dream laundry with the Otti Australia Laundry modular range of joinery, by mixing and matching the different products to fit your space and style.

Use the Sketch Page, Order Form and Component Pages on pages 23-33 to guide you in planning your laundry layout.

Start with:-

1. Drawing your layout to fit your space.
2. Consider the appliances you will use, place them in a location near you power point and near the sink for drainage and water connection for your washer.
3. Then select your storage options starting with base cabinets.
4. Add wall units for extra storage to match.
5. Add filler panels and end panels to fill the gaps.
6. Select your finishes - cabinet, handle and stone top colours.
7. Place your order!



## STEP 3 Choose your size to fit into | 1305mm

Pictured Package  
Starts from  
**\$2,389\***

\* Excludes :- Tapware, appliances,  
mirror and accessories



BONDI WHITE Package A shown fits into a 1305mm space  
( To install Wall to Wall - Please add extra Filler Panels)



# Layout using 1305mm Package

Once you know how much space you have to work with, choose your layout.

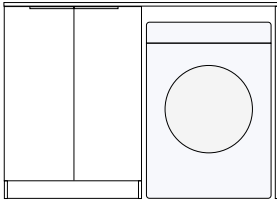
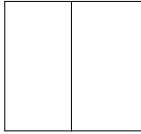

A

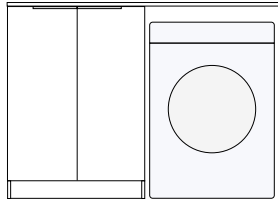

B

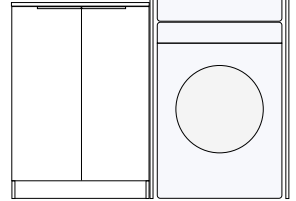

C

## Included In Package

Base Cabinet 632mm x1  
Wall Cabinet 632mm x1  
Quartz Stone Top 1300x600x20mm  
End Panel x1  
Laundry Sink Stainless Steel x1

**Byron Black Oak** RRP: 2,090  
LA-1305A-BYB-PW  
LA-1305A-BYB-NCA

**Byron Natural Oak** RRP: 2,090  
LA-1305A-BYN-PW  
LA-1305A-BYN-NCA

**Hampshire White** RRP: 2,389  
LA-1305A-BOHW-PW  
LA-1305A-BOHW-NCA

**Hampshire Black** RRP: 2,389  
LA-1305A-BOHB-PW  
LA-1305A-BOHB-NCA

**Bondi White** RRP: 2,389  
LA-1305A-BOW-PW  
LA-1305A-BOW-NCA

**Marlo Black** RRP: 2,389  
LA-1305A-MA-PW  
LA-1305A-MA-NCA

**Noosa White** RRP: 2,389  
LA-1305A-NSW-PW  
LA-1305A-NSW-NCA

Base Cabinet 632mm x1  
Wall Cabinet 632mm x2  
Quartz Stone Top 1300x600x20mm  
End Panel x1  
Laundry Sink Stainless Steel x1

**Byron Black Oak** RRP: 2,540  
LA-1305B-BYB-PW  
LA-1305B-BYB-NCA

**Byron Natural Oak** RRP: 2,540  
LA-1305B-BYN-PW  
LA-1305B-BYN-NCA

**Hampshire White** RRP: 2,988  
LA-1305B-BOHW-PW  
LA-1305B-BOHW-NCA

**Hampshire Black** RRP: 2,988  
LA-1305B-BOHB-PW  
LA-1305B-BOHB-NCA

**Bondi White** RRP: 2,988  
LA-1305B-BOW-PW  
LA-1305B-BOW-NCA

**Marlo Black** RRP: 2,988  
LA-1305B-MA-PW  
LA-1305B-MA-NCA

**Noosa White** RRP: 2,988  
LA-1305B-NSW-PW  
LA-1305B-NSW-NCA

Base Cabinet 632mm x1  
Wall Cabinet 632mm x1  
Tall Washing Machine Cabinet  
L652xH2100mmxD700 x1  
Quartz Stone Top 650x600x20mm x1  
Laundry Sink Stainless Steel x1

**Byron Black Oak** RRP: 2,905  
LA-1305C-BYB-PW  
LA-1305C-BYB-NCA

**Byron Natural Oak** RRP: 2,905  
LA-1305C-BYN-PW  
LA-1305C-BYN-NCA

**Hampshire White** RRP: 3,200  
LA-1305C-BOHW-PW  
LA-1305C-BOHW-NCA

**Hampshire Black** RRP: 3,200  
LA-1305C-BOHB-PW  
LA-1305C-BOHB-NCA

**Bondi White** RRP: 3,200  
LA-1305C-BOW-PW  
LA-1305C-BOW-NCA

**Marlo Black** RRP: 3,200  
LA-1305C-MA-PW  
LA-1305C-MA-NCA

**Noosa White** RRP: 3,200  
LA-1305C-NSW-PW  
LA-1305C-NSW-NCA

\* Excludes :- Mirror, Tapware and accessories

Note: Sink is available as an undermount only.



# Layout using 1305mm Package

Complete laundry  
cost as pictured  
**\$2,988\***

\* Excludes : Tapware appliances  
and accessories



Hampshire Matte White  
Package B shown fits into a 1305mm space



Hampshire Matte White



Layout using 1305mm Package



Complete laundry  
cost as pictured  
**\$2,905\***

\* Excludes Tapware appliances  
and accessories

Byron Black Oak  
Package C shown fits into a 1305mm space





STEP 3 Choose your size to fit into | 1715mm



Complete laundry  
cost as pictured  
**\$4,535\***

\* Excludes :-Tapware appliances,  
Bulkhead,and accessories

BONDI Fluted Matte White  
Package C shown fits into a 1715mm space  
Excludes :- Tapware,appliances and accessories



# Layout using 1715mm Package

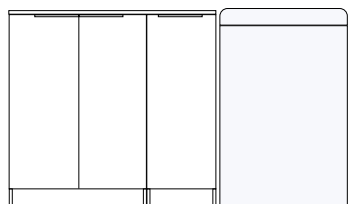

A

Base Cabinet (Double Door) 632mm x1  
Base Cabinet (Single Door) 416mm x1  
Wall Cabinet (Double Door) 632mm x1  
Wall Cabinet (Single Door) 416mm x1  
Quartz Stone Top L1060xD600xH20mm  
Laundry Sink Stainless Steel x1

**Byron Black Oak** RRP: 2,825  
LA-1715A-BYB-PW  
LA-1715A-BYB-NCA

**Byron Natural Oak** RRP: 2,825  
LA-1715A-BYN-PW  
LA-1715A-BYN-NCA

**Hampshire White** RRP: 3,310  
LA-1715A-BOHW-PW  
LA-1715A-BOHW-NCA

**Hampshire Black** RRP: 3,310  
LA-1715A-BOHB-PW  
LA-1715A-BOHB-NCA

**Bondi White** RRP: 3,310  
LA-1715A-BOW-PW  
LA-1715A-BOW-NCA

**Marlo Black** RRP: 3,310  
LA-1715A-MA-PW  
LA-1715A-MA-NCA

**Noosa White** RRP: 3,310  
LA-1715A-NSW-PW  
LA-1715A-NSW-NCA

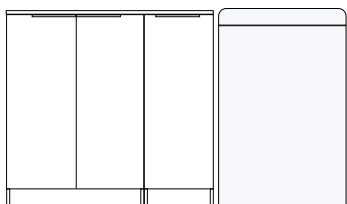
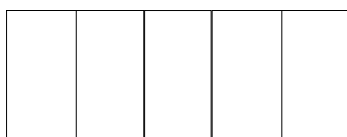

B

**Included In Package**  
Base Cabinet (Double Door) 632mm x1  
Base Cabinet (Single Door) 416mm x1  
Wall Cabinet (Double Door) 632mm x2  
Wall Cabinet (Single Door) 416mm x1  
Quartz Stone Top L1060xD600xH20mm  
Laundry Sink Stainless Steel x1

**Byron Black Oak** RRP: 3,275  
LA-1715B-BYB-PW  
LA-1715B-BYB-NCA

**Byron Natural Oak** RRP: 3,275  
LA-1715B-BYN-PW  
LA-1715B-BYN-NCA

**Hampshire White** RRP: 3,910  
LA-1715B-BOHW-PW  
LA-1715B-BOHW-NCA

**Hampshire Black** RRP: 3,910  
LA-1715B-BOHB-PW  
LA-1715B-BOHB-NCA

**Bondi White** RRP: 3,910  
LA-1715B-BOW-PW  
LA-1715B-BOW-NCA

**Marlo Black** RRP: 3,910  
LA-1715B-MA-PW  
LA-1715B-MA-NCA

**Noosa White** RRP: 3,910  
LA-1715B-NSW-PW  
LA-1715B-NSW-NCA

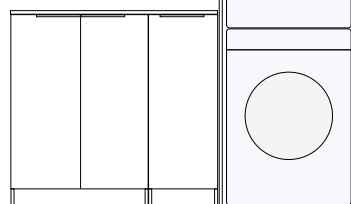
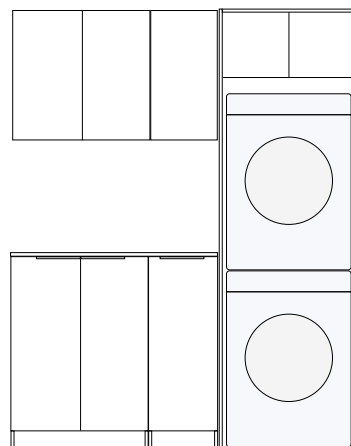

C

Base Cabinet (Double Door) 632mm x1  
Base Cabinet (Single Door) 416mm x1  
Wall Cabinet (Double Door) 632mm x1  
Wall Cabinet (Single Door) 416mm x1  
Tall Washing Machine Cabinet  
L652xH2100mmxD700 x1  
Quartz Stone Top L1060xD600xH20mm x1  
Laundry Sink Stainless Steel x1

**Byron Black Oak** RRP: 4,055  
LA-1715C-BYB-PW  
LA-1715C-BYB-NCA

**Byron Natural Oak** RRP: 4,055  
LA-1715C-BYN-PW  
LA-1715C-BYN-NCA

**Hampshire White** RRP: 4,535  
LA-1715C-BOHW-PW  
LA-1715C-BOHW-NCA

**Hampshire Black** RRP: 4,535  
LA-1715C-BOHB-PW  
LA-1715C-BOHB-NCA

**Bondi White** RRP: 4,535  
LA-1715C-BOW-PW  
LA-1715C-BOW-NCA

**Marlo Black** RRP: 4,535  
LA-1715C-MA-PW  
LA-1715C-MA-NCA

**Noosa White** RRP: 4,535  
LA-1715C-NSW-PW  
LA-1715C-NSW-NCA

Excludes :-Mirror,Tapware appliances and accessories

\* Mirror, accessories and tapware sold separately



# Layout using 1715mm Package

Complete laundry  
cost as pictured  
**\$3,910\***

\* Excludes : Tapware appliances  
and accessories





# Layout using 1715mm Package

Complete laundry  
cost as pictured  
**\$3,310\***

\* Excludes : Tapware appliances  
and accessories



BONDI Fluted Matte White  
Package A shown fits into a 1715mm space





## STEP 3 Choose your size to fit into | 1960mm

Complete laundry  
cost as pictured  
**\$4,255\***

\* Excludes :-Tapware appliances  
and accessories





# Layout using 1960mm Package

Once you know how much space you have to work with, choose your layout.

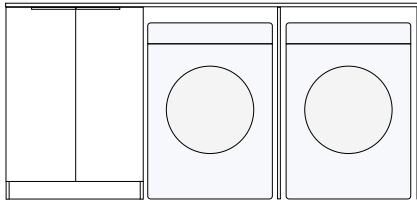
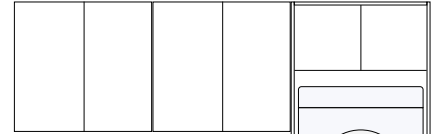
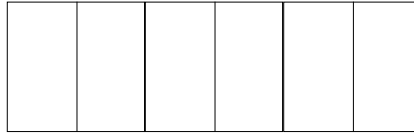
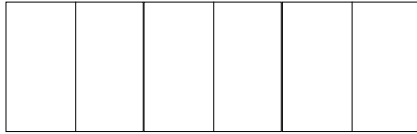

A

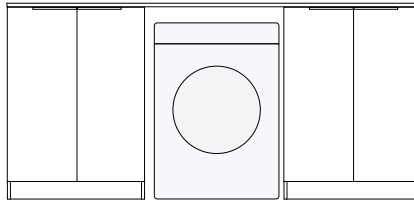

B

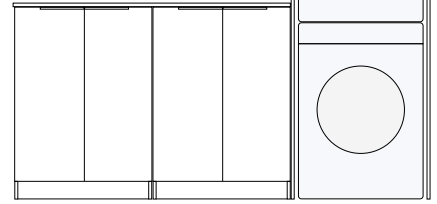

C

## Included In Package

Base Cabinet (Double Door) 632mm x1  
Wall Cabinet (Double Door) 632mm x3  
Quartz Stone Top L1960xD600xH20mm  
End Panel x 2  
Laundry Sink Stainless Steel x1

Base Cabinet (Double Door) 632mm x2  
Wall Cabinet (Double Door) 632mm x3  
Quartz Stone Top L1960xD600xH20mm  
Laundry Sink Stainless Steel x1

Base Cabinet (Double Door) 632mm x2  
Wall Cabinet (Double Door) 632mm x2  
Tall Washing Machine Cabinet  
L652xH2100mmxD700 x1  
Quartz Stone Top L1960xD600xH20mm  
End Panel x1  
Laundry Sink Stainless Steel x1

**Byron Black Oak** RRP: 3,805  
LA-1960A-BYB-PW  
LA-1960A-BYB-NCA

**Byron Natural Oak** RRP: 3,805  
LA-1960A-BYN-PW  
LA-1960A-BYN-NCA

**Hampshire White** RRP: 4,399  
LA-1960A-BOHW-PW  
LA-1960A-BOHW-NCA

**Hampshire Black** RRP: 4,399  
LA-1960A-BOHB-PW  
LA-1960A-BOHB-NCA

**Bondi White** RRP: 4,399  
LA-1960A-BOW-PW  
LA-1960A-BOW-NCA

**Marlo Black** RRP: 4,399  
LA-1960A-MA-PW  
LA-1960A-MA-NCA

**Noosa White** RRP: 4,399  
LA-1960A-NSW-PW  
LA-1960A-NSW-NCA

**Byron Black Oak** RRP: 4,158  
LA-1960B-BYB-PW  
LA-1960B-BYB-NCA

**Byron Natural Oak** RRP: 4,158  
LA-1960B-BYN-PW  
LA-1960B-BYN-NCA

**Hampshire White** RRP: 4,898  
LA-1960B-BOHW-PW  
LA-1960B-BOHW-NCA

**Hampshire Black** RRP: 4,898  
LA-1960B-BOHB-PW  
LA-1960B-BOHB-NCA

**Bondi White** RRP: 4,898  
LA-1960B-BOW-PW  
LA-1960B-BOW-NCA

**Marlo Black** RRP: 4,898  
LA-1960B-MA-PW  
LA-1960B-MA-NCA

**Noosa White** RRP: 4,898  
LA-1960B-NSW-PW  
LA-1960B-NSW-NCA

**Byron Black Oak** RRP: 4,255  
LA-1960C-BYB-PW  
LA-1960C-BYB-NCA

**Byron Natural Oak** RRP: 4,255  
LA-1960C-BYN-PW  
LA-1960C-BYN-NCA

**Hampshire White** RRP: 4,845  
LA-1960C-BOHW-PW  
LA-1960C-BOHW-NCA

**Hampshire Black** RRP: 4,845  
LA-1960C-BOHB-PW  
LA-1960C-BOHB-NCA

**Bondi White** RRP: 4,845  
LA-1960C-BOW-PW  
LA-1960C-BOW-NCA

**Marlo Black** RRP: 4,845  
LA-1960C-MA-PW  
LA-1960C-MA-NCA

**Noosa White** RRP: 4,845  
LA-1960C-NSW-PW  
LA-1960C-NSW-NCA

\* Excludes :- Tapware and accessories

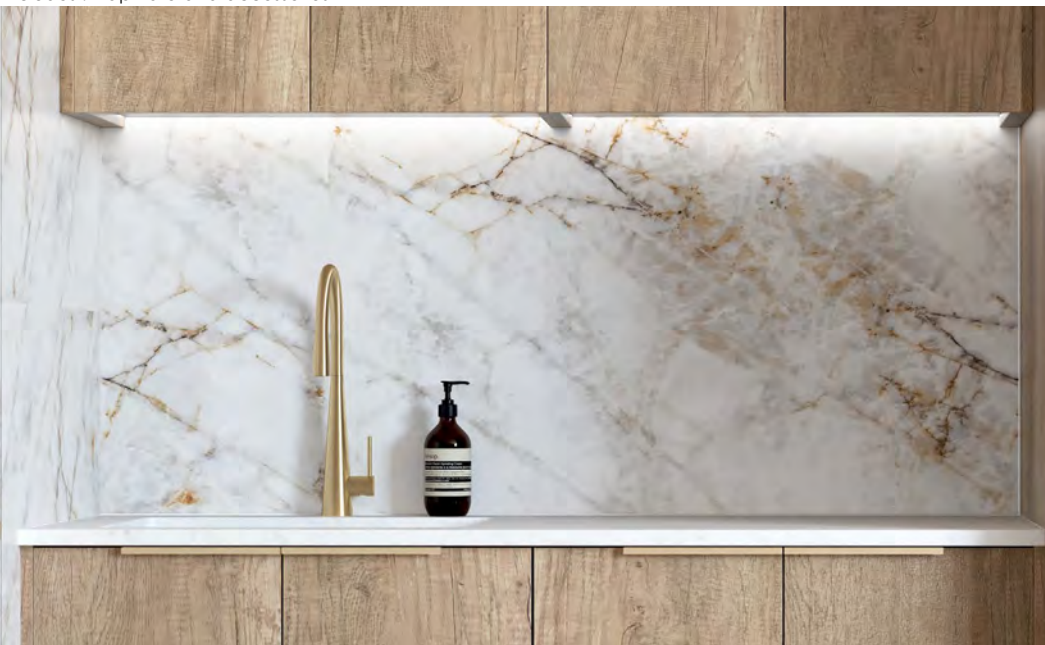

# Layout using 1960mm Package





# Layout using 1960mm Package

Complete laundry  
cost as pictured

**\$4,158\***

\* Excludes 1- Tapware appliances  
and accessories



Package B shown fits into a 1960mm space

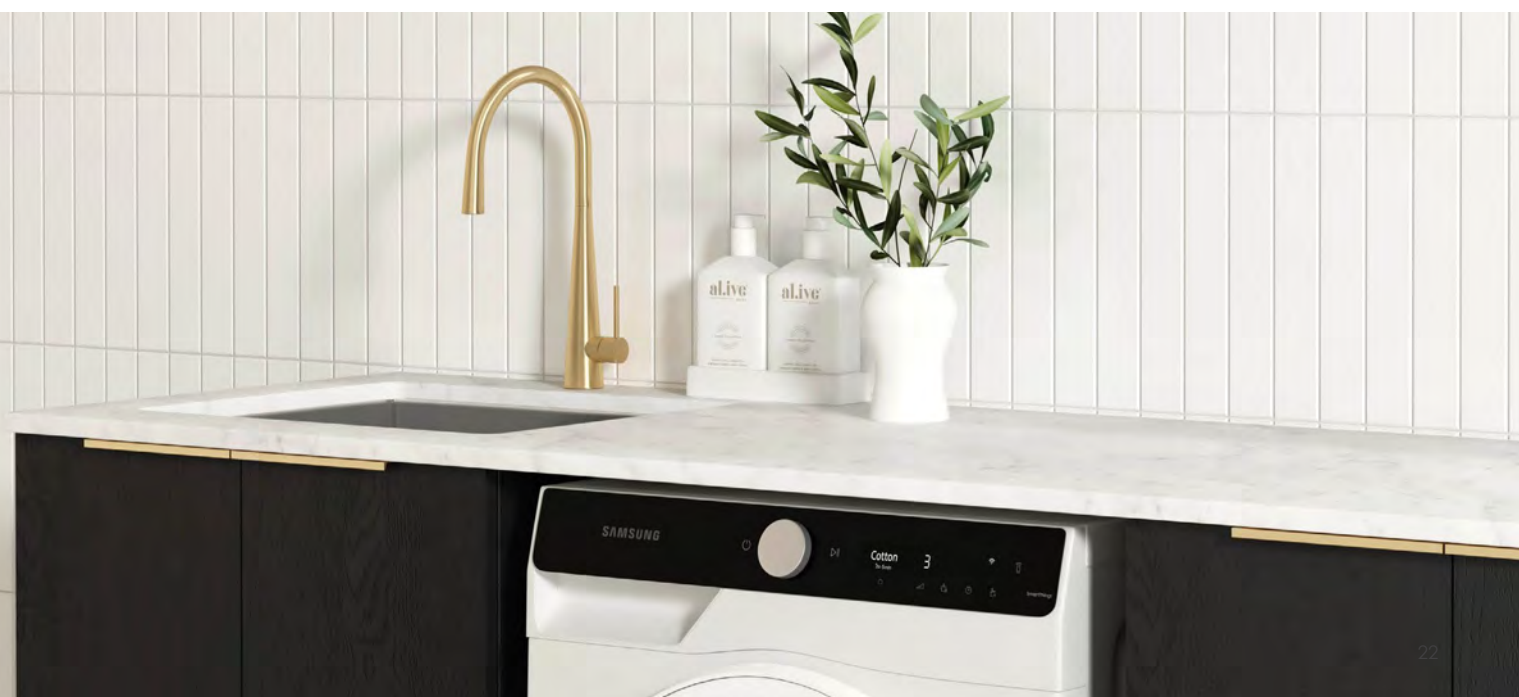

# Floor Cabinets Double Door

Bevel Finger Pull or Handle options  
632mm

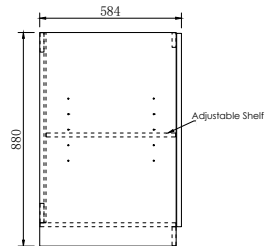
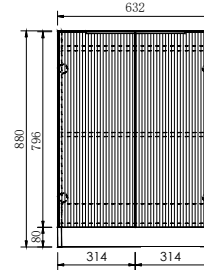
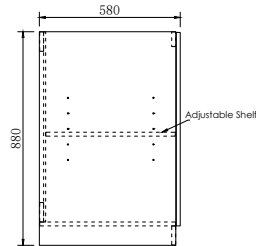
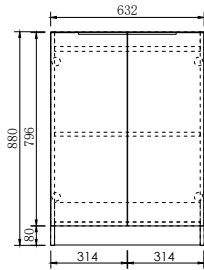
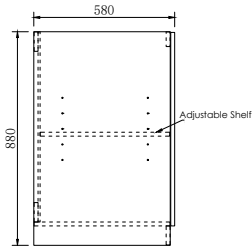
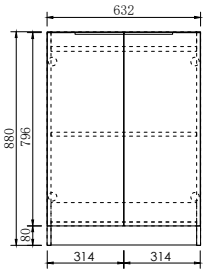
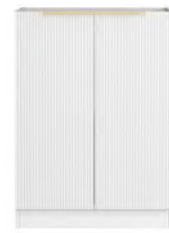

**Byron Natural Oak** Floor Cabinet 632mm  
2 Doors With Handles

LA-BY600N Natural Oak RRP: \$630

**Byron Black Oak** Floor Cabinet 632mm  
2 Doors With Handles

LA-BY600B Black Oak RRP: \$630

**Bondi** Floor Cabinet 632mm  
2 Doors With Handles

LA-BO600W Matte White RRP: \$775

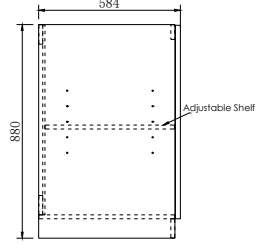
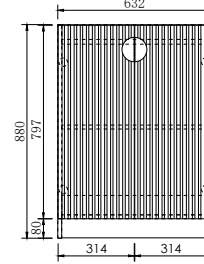
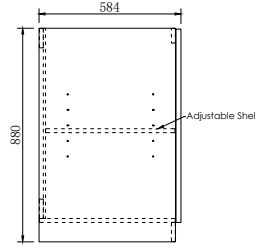
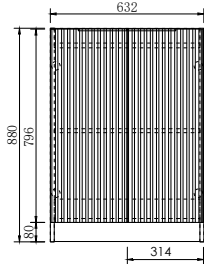
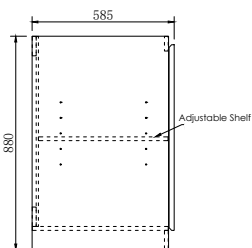
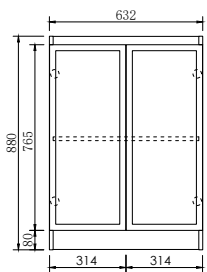

**Hamshire Matte White&Matte Black**  
Floor Cabinet 632mm 2 Doors Bevel Finger Pull

LA-BOH600W Matte White RRP: \$775

LA-BOH600B Matte Black RRP: \$775

**Noosa Matte White** Floor Cabinet 632mm  
2 Doors With Handles

LA-NS600W Matte White RRP: \$775

**Marlo** Floor Cabinet 632mm  
2 Doors With Handles

LA-MA600B Matte Black RRP: \$775

## End Panel Floor Cabinets 880x580x16mm



**Natural Oak**  
LA-EP880N RRP: \$139



**Black Oak**  
LA-EP880BO RRP: \$139

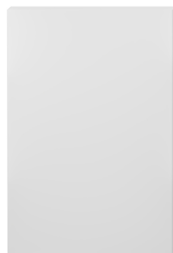

**Matte White**  
LA-EP880W RRP: \$139



**Matte Black**  
LA-EP880B RRP: \$139

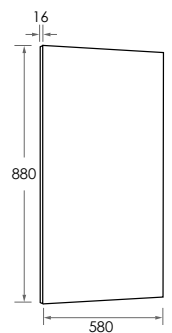



# Floor Cabinets Single Door

Bevel Finger Pull or Handle options

416mm

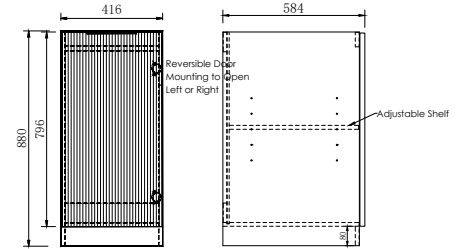
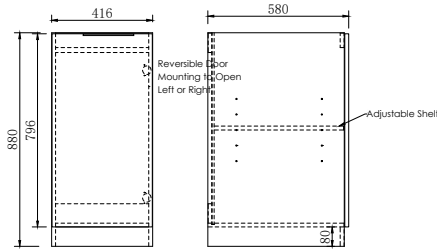
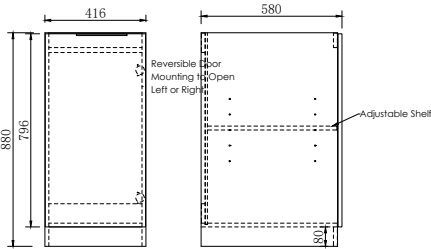

**Byron Natural Oak** Floor Cabinet 416mm  
1 Door With Handle

LA-BY400N Natural Oak RRP: \$595

**Byron Black Oak** Floor Cabinet 416mm  
1 Door With Handle

LA-BY400B Black Oak RRP: \$595

**Bondi** Floor Cabinet 416mm  
1 Door With Handle

LA-BO400W Matte White RRP: \$700

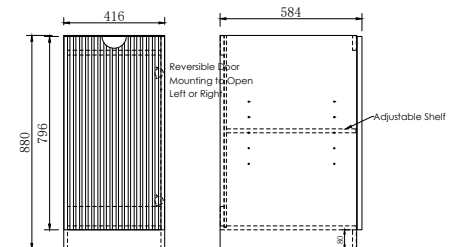
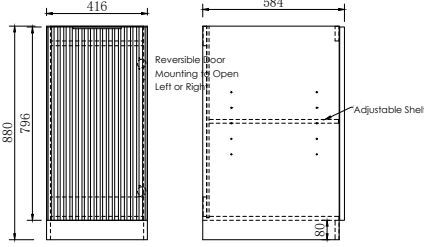
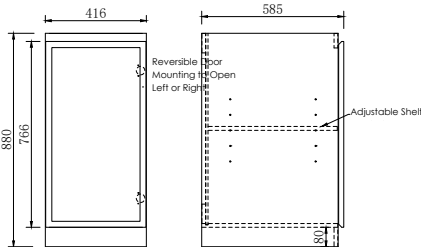

**Hampshire Matte White&Matte Black**  
Floor Cabinet 416mm 1 Door Bevel Finger Pull

LA-BOH400W Matte White RRP: \$700  
LA-BOH400B Matte Black RRP: \$700

**Noosa Matte White** Floor Cabinet 416mm  
1 Door With Handle

LA-NS400W Matte White RRP: \$700

**Marlo** Floor Cabinet 416mm  
1 Door With Handle

LA-MA400B Matte Black RRP: \$700

## Filler Panel

Floor Cabinets 880x140x16mm

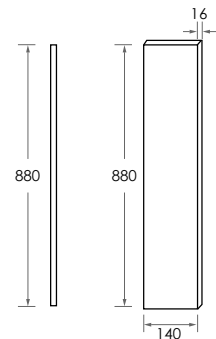

**Natural Oak**  
LA-FL140N RRP:\$37

**Black Oak**  
LA-FL140BO RRP:\$37

**Matte White**  
LA-FL140W RRP:\$37

**Matte Black**  
LA-FL140B RRP:\$37

# Wall Cabinets Double Door

Bevel Finger Pull  
632mm



- When using 2 different designer cabinets , note that the depths vary so it is important to pack out the back of each cabinet to ensure the facings are all level and flush.

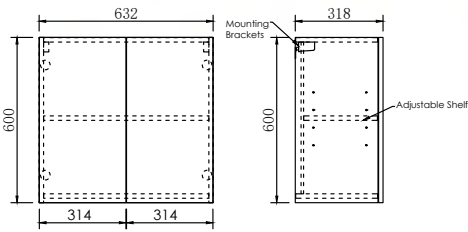

**Byron Natural Oak** Wall Cabinet 632mm  
2 Doors Bevel-Grip Finger Pull

LA-WCBY600N Natural Oak RRP: \$450

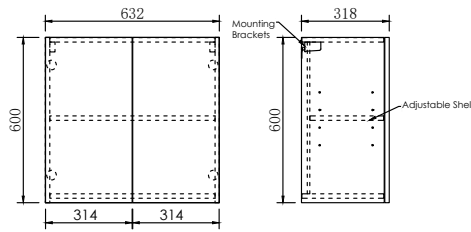

**Byron Black Oak** Wall Cabinet 632mm  
2 Doors Bevel-Grip Finger Pull

LA-WCBY600B Black Oak RRP: \$450

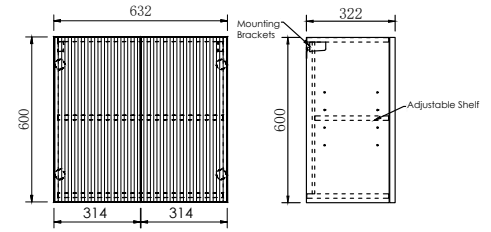

**Bondi** Wall Cabinet 632mm  
2 Doors Bevel-Grip Finger Pull

LA-WCBO600W Matte White RRP: \$600

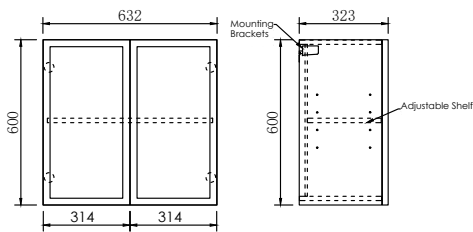

**Hampshire Matte White & Matte Black**  
Wall Cabinet 632mm 2 Doors Bevel Finger Pull

LA-WCBOH600W Matte White RRP: \$600  
LA-WCBOH600B Matte Black RRP: \$600

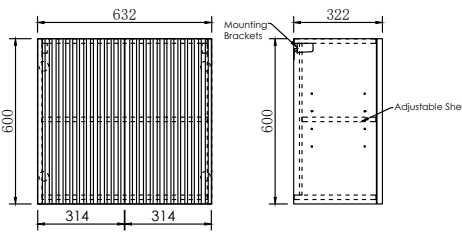

**Noosa Matte White** Wall Cabinet 632mm  
2 Doors Bevel Finger Pull

LA-WCNS600W Matte White RRP: \$600

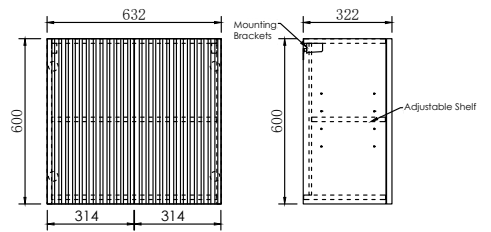
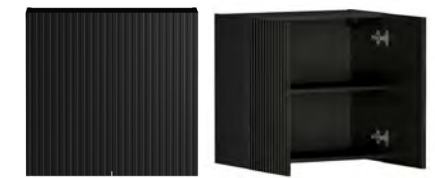

**Hampshire Matte Black** Wall Cabinet 632mm  
2 Doors Bevel Finger Pull

LA-WCBOH600B Matte Black RRP: \$600

# Wall Cabinets Single Door

Bevel Finger Pull  
416mm

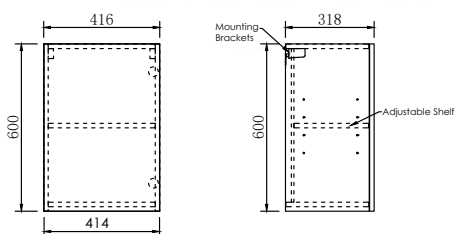

**Byron Natural Oak** Wall Cabinet 416mm  
Single Door Bevel Finger Pull

LA-WCBY400N Natural Oak RRP: \$380

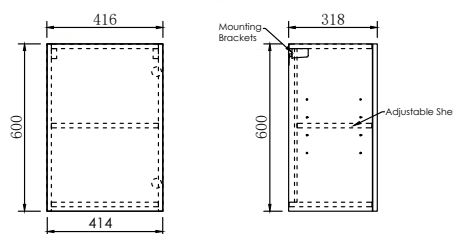

**Byron Black Oak** Wall Cabinet 416mm  
Single Door Bevel Finger Pull

LA-WCBY400B Black Oak RRP: \$380

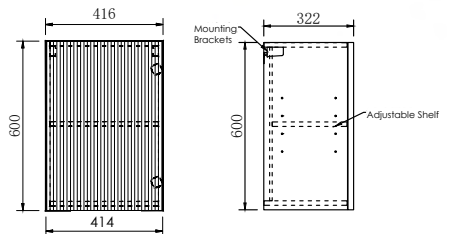



**Bondi** Wall Cabinet 416mm  
Single Door Bevel Finger Pull

LA-WCBO400W Matte White RRP: \$460



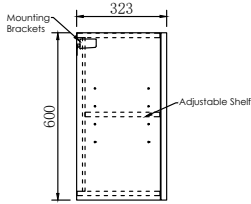
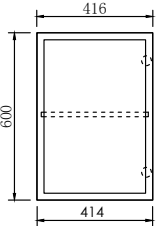

416mm



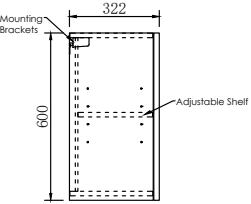
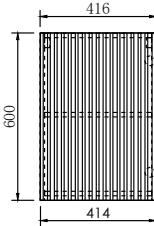

**Hampshire Matte White&Matte Black**  
Wall Cabinet 416mm Singer Door Bevel Finger Pull

LA-WCBOH400W	Matte White	RRP: \$460
LA-WCBOH400B	Matte Black	RRP: \$460



**Noosa Matte White** Wall Cabinet 416mm  
Singer Door Bevel Finger Pull

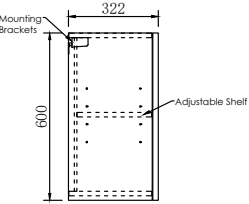
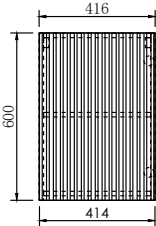



LA-WCNS400W	Matte White	RRP: \$460
-------------	-------------	------------



**Marlo** Wall Cabinet 416mm  
Singer Door Bevel Finger Pull

LA-WCMA400B	Matte Black	RRP: \$460
-------------	-------------	------------

Filler Panel  
Wall Cabinets 600x140x16mm



**Natural Oak**      **Black Oak**      **Matte White**      **Matte Black**

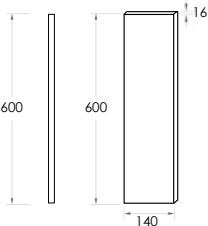

600 600 140 16

Wall Cabinets Filler  
600x140x16mm

LA-FL140BO-W	Black Oak	RRP:\$29
LA-FL140N-W	Natural Oak	RRP:\$29
LA-FL140B-W	Matte Black	RRP:\$29
LA-FL140W-W	Matte White	RRP:\$29

Washing Machine Cabints Bevel-Grip Finger Pull  
Double Door

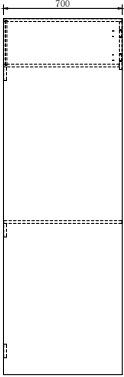

**Washing Machine Cabinet 652mm - 2 Doors**  
Bevel-Grip Finger Pull

LA-TWBY652B	Black Oak	RRP:\$1,225
LA-TWBY652N	Natural Oak	RRP:\$1,225



**Washing Machine Cabinet 652mm - 2 Doors**  
Bevel-Grip Finger Pull

LA-TW652W	Matte White	RRP:\$1,225
LA-TW652B	Matte Black	RRP:\$1,225

## Cabinet Colour & Finishes

### Timber Grain

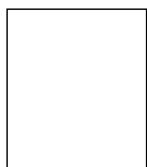

Byron



Black Oak



Natural Oak

### Panelled

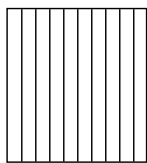

Marlo&Noosa



Marlo Matte Black



Noosa Matte White

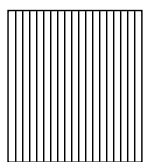

Bondi



Matte White

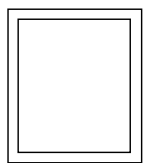

Hampshire



Matte White

## Handle Options

Finish Electroplated PVD Handles

**Byron, Bondi** RRP: \$20 Each  
Brushed Gold (Optional Colours available as extra)



Matte Black  
BOHANDLE-B200



Brushed Gold  
BOHANDLE-G200



Brushed Nickel  
BOHANDLE-BN200

**Marlo** RRP: \$20 Each  
Matte Black (Optional Colours available as extra)



Matte Black  
MLHANDLE-B



Brushed Gold  
MLHANDLE-BG



Chrome  
MLHANDLE

**Hampshire**  
Bevel Finger Pull

## Laundry Stonetop

20mm Stone Top

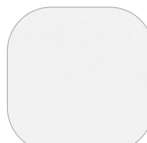

Quartz Stone  
Pure White

18mm Stone Top

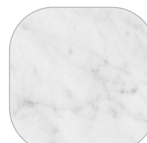

Natural  
Carrara





# Kitchen&Laundry Accessories

HAND MADE SINK 520X440X220

Pull Out Kitchen & Laundry Mixer 4 Star -7.5L/min  
Reg.No.1486

Brushed Finish High Quality  
1.2mm 304 Grade Stainless Steel  
Radiused Corners for Easy Cleaning  
Ideal for Kitchen and Laundry Applications  
Basket Wastes Included  
Sink is available as an undermount only

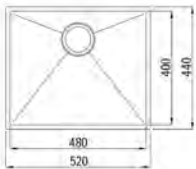

**Axon 52S M-CBS-810-52**  
Outer Dimension:  
520X440X220mm  
Basket Wastes Included

Included in Packages  
RRP:\$250



**Axon 52S M-CBS-810-52BG**  
Brushed Gold  
Outer Dimension:  
520X440X220mm  
Basket Wastes Included

Upgrade to Brushed Gold  
Extra \$118 RRP \$368



**Axon 52S M-CBS-810-52GM**  
Gun Metal  
Outer Dimension:  
520X440X220mm  
Basket Wastes Included

Upgrade to Gun Metal  
Extra \$118 RRP \$368

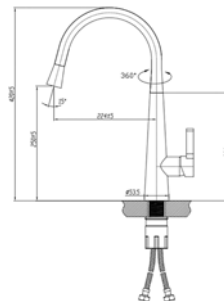

Chrome	PKM004	RRP:\$377
Black	PKM004-B	RRP:\$416
Brushed Nickel	PKM004-BN	RRP:\$450
Gun Metal	PKM004-GM	RRP:\$536
Brushed Gold	PKM004-BG	RRP:\$536



# LAUNDRY STONE TOP COLLECTION

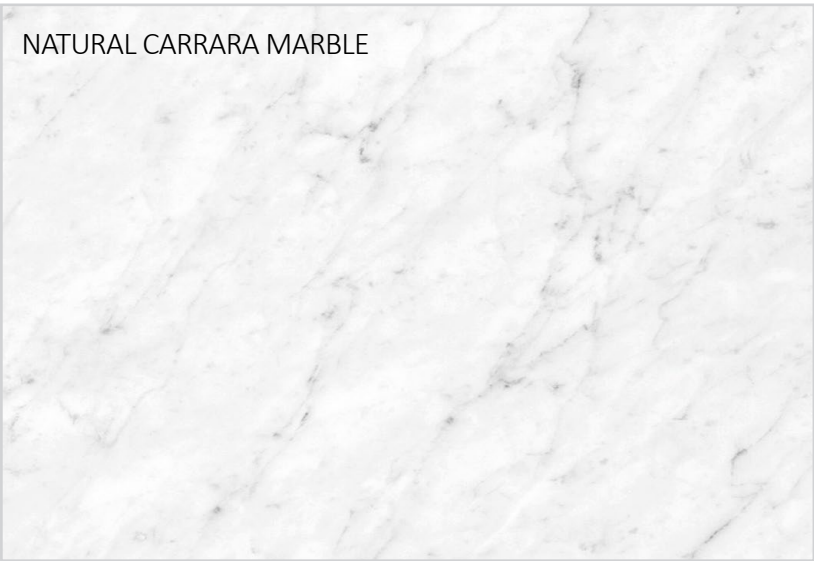

NATURAL CARRARA MARBLE

- STLA650-NCA: 650X600X18mm Natural Carrara vanity top RRP: \$350
- STLA1060-NCA: 1060X600X18mm Natural Carrara vanity top RRP: \$525
- STLA1300-NCA: 1300X600X18mm Natural Carrara vanity top RRP: \$620
- STLA1960-NCA: 1960X600X18mm Natural Carrara vanity top RRP: \$1,298

Features: Material:- Natural Stone Carrara  
Universal Pre-Drilled Taphole

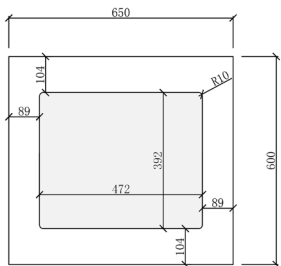

Top View

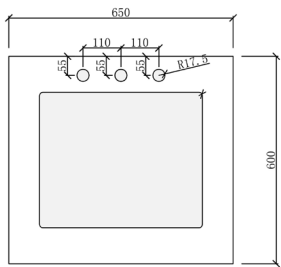

Back View  
Pre Semi-Drilling Tapholes

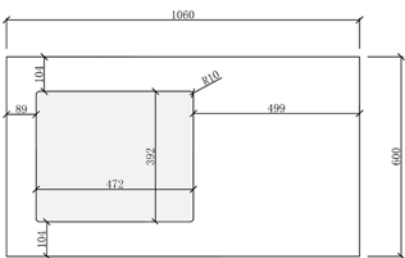

Top View

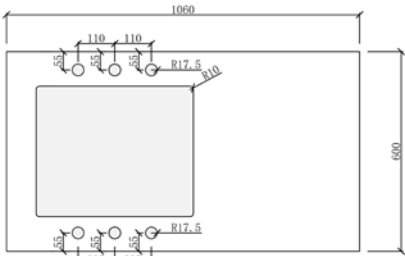

Back View  
Pre Semi-Drilling Tapholes

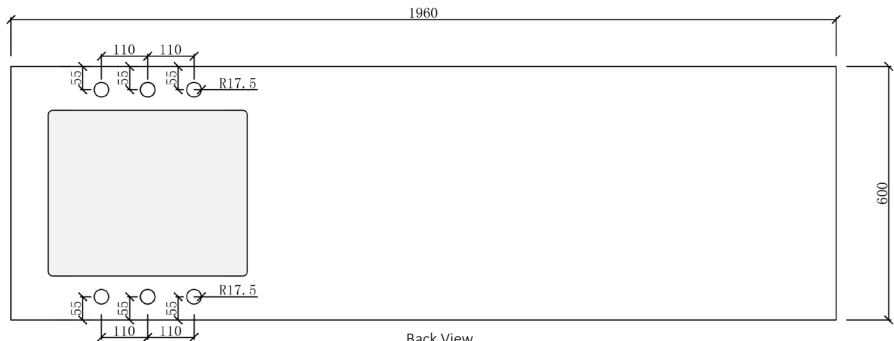

Back View  
Pre Semi-Drilling Tapholes



PURE WHITE

- STLA650-PW: 650X600X20mm Ultra Deluxe vanity top RRP: \$350
- STLA1060-PW: 1060X600X20mm Ultra Deluxe vanity top RRP: \$525
- STLA1300-PW: 1300X600X20mm Ultra Deluxe vanity top RRP: \$620
- STLA1960-PW: 1960X600X20 mm Ultra Deluxe vanity top RRP: \$1,298

Features: Material:- Solid Surface Stone Matte  
Universal Pre-Drilled Taphole

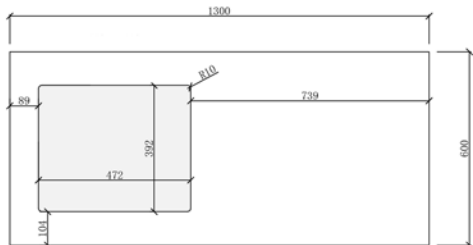

Top View

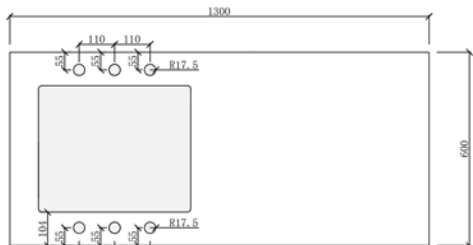

Back View  
Pre Semi-Drilling Tapholes

**TIPS**  
Polished All Four- Sided ,Stone tops can be installed with kitchen sink on left or right,(650mm only 3 Sided).  
Sink not included

**Note:** Sink is available as an undermount only.



# LAUNDRY CABINET FINISHINGS COLLECTION

Laminated Wood Grain Texture Natural Oak, Black Oak, Matte Black or Matte White + Moisture Resistant Plywood

MARLO  
Polyurethane Matte Black  
Moisture Resistant Plywood

HAMPSHIRE, BONDI WHITE  
Polyurethane Matte White  
Moisture Resistant Plywood

BYRON/BONDI  
Natural Oak  
Moisture Resistant Plywood

BYRON  
Black Oak  
Moisture Resistant Plywood



### Sketch your Layout

Using your measurements, and our module units you can customise your layout.

- Draw in floor, windows, doors, into the grid.

Each square represents 10cm or 10 x squares = 1metre

- Draw in plumbing, light switches and electrical points.

- Make sure you have access points for installing - will your joinery fit through your door.

- Draw in water and electrical connections, mark out drainage points.

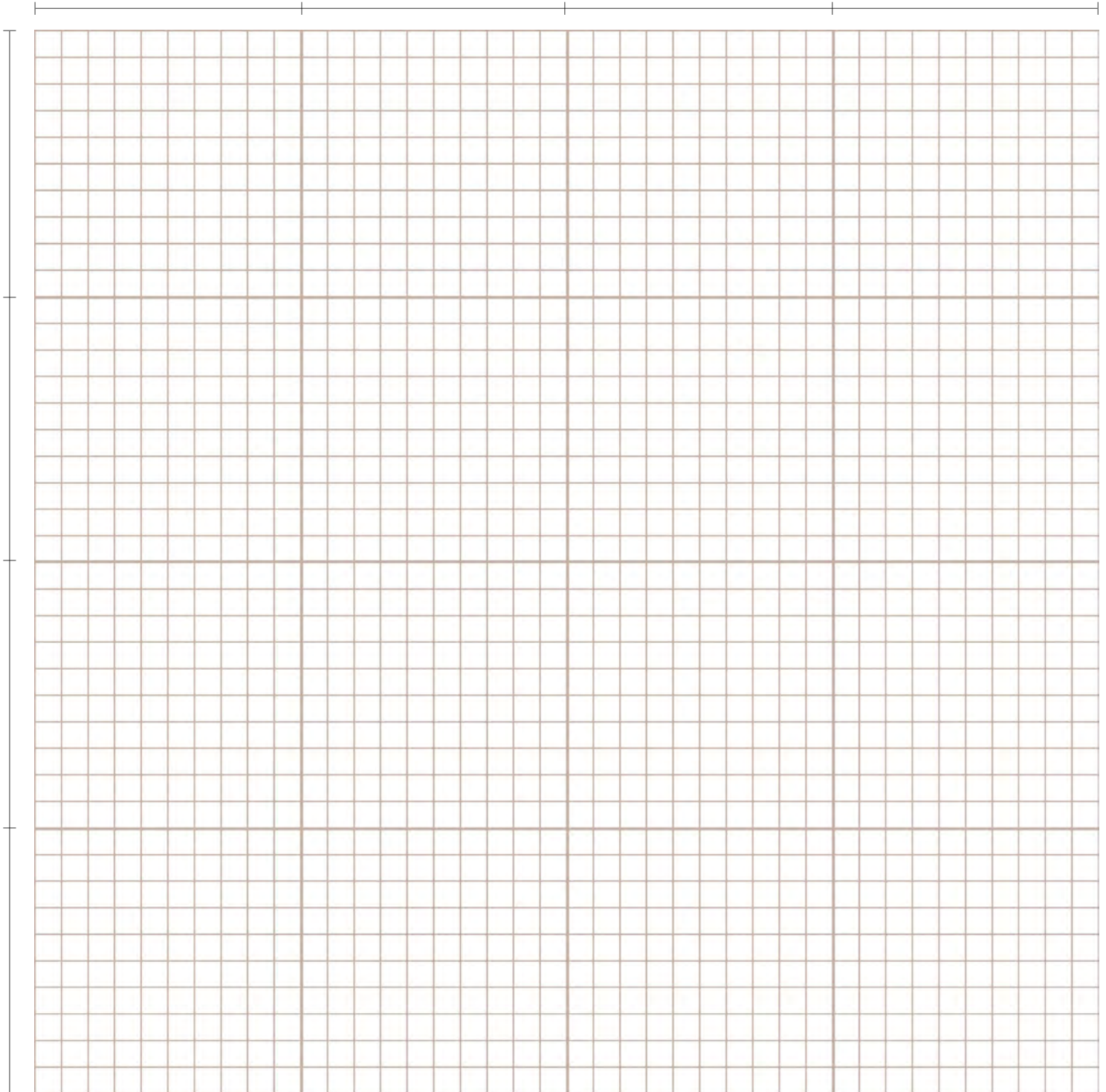

10cm or 10 x squares = 1metre



# MODULAR LAUNDRY SYSTEM ORDER FORM

Step 5-  
Order Form

To make life easy, fill this form, enter quantities in correspondin boxes below.

Email [orders@ottiaustralia.com.au](mailto:orders@ottiaustralia.com.au)

## STORE

Store Name

Completed By

Purchase Order No

Date

## CUSTOMER DETAILS

Name

Customer  
Contact No.

Customer Signature

Customer Email

## MODULAR LAUNDRY SYSTEM

### TIMBER GRAIN RANGE

### HANDLE

Bondi /Byron Natural Oak

Bondi Matte Black

Bondi /Byron Black Oak

Bondi Brushed Gold

Bondi Brushed Nickel

### PANELLED RANGE

### HANDLE

Hampshire Matte White

Finger Pull

Hampshire Matte Black

### PANELLED RANGE

### HANDLE

Noosa Matte White

Bondi Matte Black

Bondi Matte White

Bondi Brushed Gold

Bondi Brushed Nickel

Marlo Matte Black

Marlo Matte Black

Marlo Brushed Gold

Marlo Brushed Nickel



# MODULAR LAUDRY SYSTEM

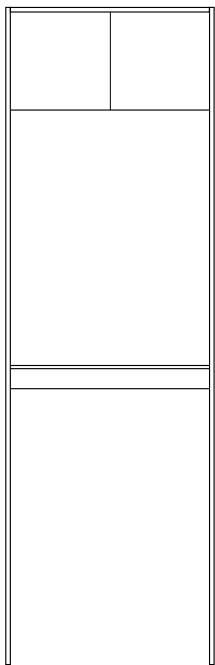

Tall Tower Cabinet

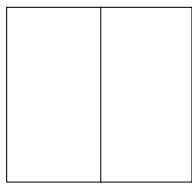

Wall Cabinet 630



Wall Cabinet 416



Wall End Panel



Wall Filler Panel

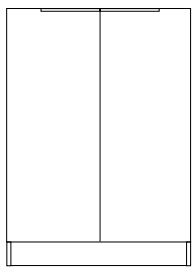

Floor Cabinet 630



Floor Cabinet 416



Floor End Panel

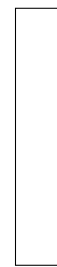

Floor Filler Panel



## STONE TOP

### STONE

Natural Carrara



Pure White



### STONE SIZE

650mm



1060mm



1300mm



1960mm



## SINK

### SINK - Undermount

Stainless Steel



Brushed Gunmetal



Brushed Gold





# WARRANTY

**NOTE: Unless otherwise stated warranties for Otti Australia products are as follows:-**

## PRODUCTS

## DOMESTIC WARRANTY Product Replacement

## COMMERCIAL WARRANTY Product Replacement

Laundry Cabinet  
Kitchen Sink  
Stone Tops

10 years  
10 years  
10 years

12 Months  
12 Months  
12 Months

All products Parts and labour - 12 Months

This warranty only applies to defects which have arisen solely from faulty materials or workmanship in the Products. Our products come with guarantees that cannot be excluded under the Australian Consumer Law. A replacement or refund will be offered for any major failure, upon inspection by an authorised representative where a product is found to be defective in construction, material or assembly. Goods maybe repaired or replaced if the goods fail to be of acceptable quality and the failure does not amount to a major failure.

The warranty does not apply to other defects which may have arisen as a result of, without limitation, the following: accidental damage, abnormal stress or strain, harsh or adverse weather conditions, abuse, misuse, mistreatment including excessive water pressure, temperature, or neglect of any kind of the products. Alterations and repairs of the Products other than by an accredited and licensed service agent or technician are not covered.

## CONDITIONS

1. Items must be installed by a licensed tradesperson.
2. Failure is due to a fault in the manufacture of the product.
3. Proof of purchase is provided.
4. The installation of the product is in accordance with the instructions provided.

## EXCLUSIONS

To the fullest extent permitted by law, the manufacturer excludes all liability for damage or injury to any person, damage to any property and any indirect consequential or other loss or damage. Manufacturer will not be liable for the cost of installation or removal of any unit and the warranty will be VOIDED if damage occurred during or after INSTALLATION or a damaged or incorrect unit has been installed. Door and drawer adjustment; Unsuitable or improper use; Incorrect installation or installation not in accordance with the instructions provided; Installation or part installation by the purchaser or any person other than a LICENSED tradesperson; Normal wear and tear; Inadequate or complete lack of maintenance; water damage; chemical, electrochemical or electrical influences; excessive heat damage or Harsh detergents or abrasive cleaners used on product finishes, are NOT considered a warranty issue.

## To Make a claim:-

For all warranty queries customers are to contact the branch where the product was purchased. These details can be found on your purchase invoice. Please provide them with photos or/video or issue if applicable, to illustrate issue clearly.

Login to our website portal and entry you details into the Customer Warranty Request Form.

<https://www.ottiaustralia.com.au/page/5/warranty>

## SERVICE CALL OUT FEES & CHARGES

In the event of a call out for issues covered under the OTTI manufacturer warranty, no call out fees apply.

If Otti Australia is called out and the cause of the issue falls within the warranty exclusions or the installation instructions have not been adhered to, the following charges will apply:

- Call out fee: \$200.00 initial cost, first 15 minutes included.
- Service time onsite: \$30/ billed in 15 minute increments.
- Call out times: Business hours 9am - 5pm.

Note: Response time will depend on technician availability.

## PRODUCT CARE AND MAINTANCE

### **Solid Surface Basins**

Everydaycare cleaning of Otti Australia Solid Surface products, to remove dirt and grime that may build up on the surface, can be removed with a simple wipe using a damp soapy sponge or cloth,

### **Joinery**

Everydaycare cleaning of Otti Australia cabinets products, to remove dust or dirt that may build up on the surface, can be removed with a simple wipe using a damp soapy sponge or cloth.



**otti**  
australia

**VOGUE**  
LIVING

**ArchiPro.**

[www.ottiaustralia.com.au](http://www.ottiaustralia.com.au)

Available from all leading bathroom retail stores. Go to [www.ottiaustralia.com.au/](http://www.ottiaustralia.com.au/) stockists to find a stockists near you. Due to limitations in the printing process the colours in this catalogue are guide only. All measurements within this catalogue are nominal and are subject to change. Specifications correct at time of printing 02/2023. Please visit [www.ottiaustralia.com.au](http://www.ottiaustralia.com.au) for most current technical information.



@ottiaustralia